

CRUISE SHIP PIER AND TERMINAL FACILITY SPECIFICATION OVERVIEW

クルーズ係留施設及びターミナル施設概要

As of 01/01/2021
2021年1月1日現在

■Common Information

共通情報

PORT NAME: Port of Hakodate 港名：函館港		
LOCATION / ADDRESS: 4-13 Shinonome-cho, Hakodate City, Hokkaido 040-8666 Japan 住所：〒040-8666 函館市東雲町 4-13		
PORT CONTACT: Port and Airport Department, City of Hakodate 連絡先：函館市 港湾空港部		
Phone: +81-138-21-3493 電話：	Fax: +81-138-26-2656	E-mail: port-dev@city.hakodate.hokkaido.jp
Mobile phone: 携帯：	Website: https://www.city.hakodate.hokkaido.jp/docs/2019020800086/	Other: その他：

I. CRUISE SHIP RECORD (OVER THE PAST FIVE YEARS)

寄港実績（過去5年）

Ship name 船名：	Gross tonnage 総トン数：	LOA 全長：	Draft 喫水：	Maiden call (Year) 初寄港年：
Due to the outbreak of COVID-19, all expected callings were canceled in 2020.				
AZAMARA QUEST	30,277	181.00	5.95	2019
QUEEN ELIZABETH	90,901	294.00	7.90	2019
SILVER MUSE	40,791	212.80	6.70	2019
QUANTUM OF THE SEA	168,666	347.08	8.82	2019
MSC SPLENDIDA	137,936	333.33	8.68	2019
CRYSTAL SYMPHONY	51,044	238.01	8.00	2019
MAASDAM	55,575	219.21	7.72	2019
GOLDEN PRINCESS	108,865	289.51	8.45	2018
STAR LEGEND	9,961	133.80	5.50	2018
NORWEGIAN JEWEL	93,502	294.13	8.60	2018
COSTA SERENA	114,261	289.59	8.30	2018
WESTERDAM	82,862	285.24	8.00	2018
SEABOURN SOJOURN	32,477	198.19	6.70	2017
COSTA neoROMANTICA	56,769	220.52	7.60	2017
OCEAN DREAM	32,265	204.76	7.10	2017
COSTA ATLANTICA	85,619	292.56	8.00	2016
LAUSTRAL	10,944	142.10	4.80	2015
SILVER DISCOVERER	5,218	102.97	4.31	2015
SAPPHIRE PRINCESS	115,875	290.00	8.55	2015

■ Wharf (Pier) Information

埠頭別情報

Wharf (Pier) name: Wakamatsu Wharf (Provisional Service) ふ頭名：若松ふ頭（暫定供用）		
III. PHYSICAL CONSIDERATIONS 物理的留意事項		
1. Berth 岸壁	Length / Water depth 延長/水深	<ul style="list-style-type: none"> • 360m / -8m *Expected to start in 2021: 360m/-9m *After full service starts in 2022: 360m/-10m
	Height of the pier above MLW or chart datum (平均干潮位又は海図基準からの) 岸壁の高さ	<ul style="list-style-type: none"> • 3m
	Pier depth (distance to the closest obstruction behind the pier edge) 岸壁の幅 (岸壁の端から背後障害物までの距離)	<ul style="list-style-type: none"> • 20m
	Minimum depth across the berth 岸壁の最低水深	<ul style="list-style-type: none"> • -8m *Expected to start in 2021: - 9m *After full service starts in 2022: -10m
	Fender bar 防舷材 Absorbed energy / number of the fender bars 吸収エネルギー/本数	<ul style="list-style-type: none"> • 283kN・m, V Shape L:2,000 x H:800 / 12pcs @20m, 25m
	Bollard 係船柱 Specification / number of the bollards スペック/本数	<ul style="list-style-type: none"> • Jetty: 1,000kN / 12pcs @20m, 25m • Dolphin: 1,500kN / 4pcs @25m, 30m
2. Channel 航路	Width / water depth 幅/水深	<ul style="list-style-type: none"> • 300m / -10~-16m
3. Turning basin (diameter) 回頭泊地 (直径)		<ul style="list-style-type: none"> • 467m by -8m *After full service starts: 502m by -10m
4. Clearance 高さ制限		<ul style="list-style-type: none"> • No Limit
5. Maximum tidal range / max currents 最大潮差/最大潮流		<ul style="list-style-type: none"> • 1.1m / 0.1knot
6. Wind & weather conditions / tides by season 風及び季節による天候/潮汐の変化		<ul style="list-style-type: none"> • Less than 5m/s (82.3%) and more than 10m/s (0.6%) [Mar-May] W or WNW: 50%, [Mar-May] Less than 0.1knot: 71%, [Mar-May] More than 0.2knot: 2% [Jun-Aug] E or ESE: 77%, [Jun-Aug] Less than 0.1knot: 82%, [Jun-Aug] More than 0.2knot: 1% [Sep-Nov] W or WNW: 55%, [Sep-Nov] Less than 0.1knot: 77%, [Sep-Nov] More than 0.2knot: 1%

IV. LANDSIDE FACILITIES		
陸上施設		
1. Terminal ターミナル等	Terminal Availability ターミナルの有無	Not available (in preparation)
	Shelter or facilities to shelter from rain (無い場合) 雨よけ施 設の有無	Not available
	Boarding Bridge ボーディングブリッジ	Not available
2. Shore gangway ギャングウェイ		Not available
3. Pay phone 公衆電話		Not available
4. Restroom / washroom トイレ		Not Available (There are some restrooms nearby.)
5. Vending machine / kiosk 自動販売機・売店		Not available (There are some shops nearby.)
6. Need to arrange shuttles to downtown? 市街地へシャトルバスが必要か		No
7. Distance and time to downtown? 市街地までの距離・時間		300m / 3min on foot
8. Distance and time to primary sightseeing area 主要観光地までの距離・時間		Morning Market: 300m / 3min on foot
V. CUSTOMS AND IMMIGRATION		
税関及び入国管理		
1. Availability of CIQ services and facilities CIQ の有無	Permanent 常設	
	Temporary 仮設 (船上を含む)	Yes
2. Secure electronic access 自動化出入国ゲートの有無		Not available
VI. WORKING HOURS		
サービス提供時間		
1. Pilotage パイロット		24hrs
2. Tugage タグ		24hrs
3. Line handling 綱とり		24hrs
4. Other (pls specify) その他		
VII. SECURITY		
セキュリティ		
1. ISPS certified? ISPS の認定有無		Yes

VIII. TRANSPORTATION 交通機関		
1. Parking for tour buses (number of buses) 観光バス待機所 (駐車台数)		Approximately 20 (parking area in front of the wharf)
2. Parking for private cars (number of cars) 自家用車駐車場 (駐車台数)		Not available
3. Parking for taxis (number of taxis) タクシープール (駐車台数)		Approximately 10
4. Name of the nearest airport from the pier ふ頭から最も近い空港の名称		Hakodate Airport
5. Time from the pier to the airport by car ふ頭から空港までの車での移動時間		20min
6. Name of the nearest rail station from the pier ふ頭から最も近い鉄道駅の名称		JR Hakodate Station
7. Time from the pier to the rail station by car ふ頭から鉄道駅までの車での移動時間		5min (on foot)
IX. TERMINAL SERVICE ターミナル内のサービス		
1. Wi-Fi service Wi-Fi サービス		Not available
2. Postal & delivery service 郵便・宅配便サービス		Not available
3. Foreign exchange 外貨両替所	Availability 両替所の有無	Not available
	Kinds of currencies 取り扱い貨幣の種類	
	Business hours・days 営業時間・営業日	
4. Tourist information 観光案内所	Availability 観光案内所の有無	Available (temporary)
	Language 対応言語	English, Japanese
	Business hours・days 営業時間・営業日	Temporary

X. REFERENCE INFORMATION

参考情報

Wharf position figure

ふ頭位置図

<https://www.city.hakodate.hokkaido.jp/docs/2019020800086/>

Figure of the terminal placement and passenger line of flow

ターミナル配置図と受入動線

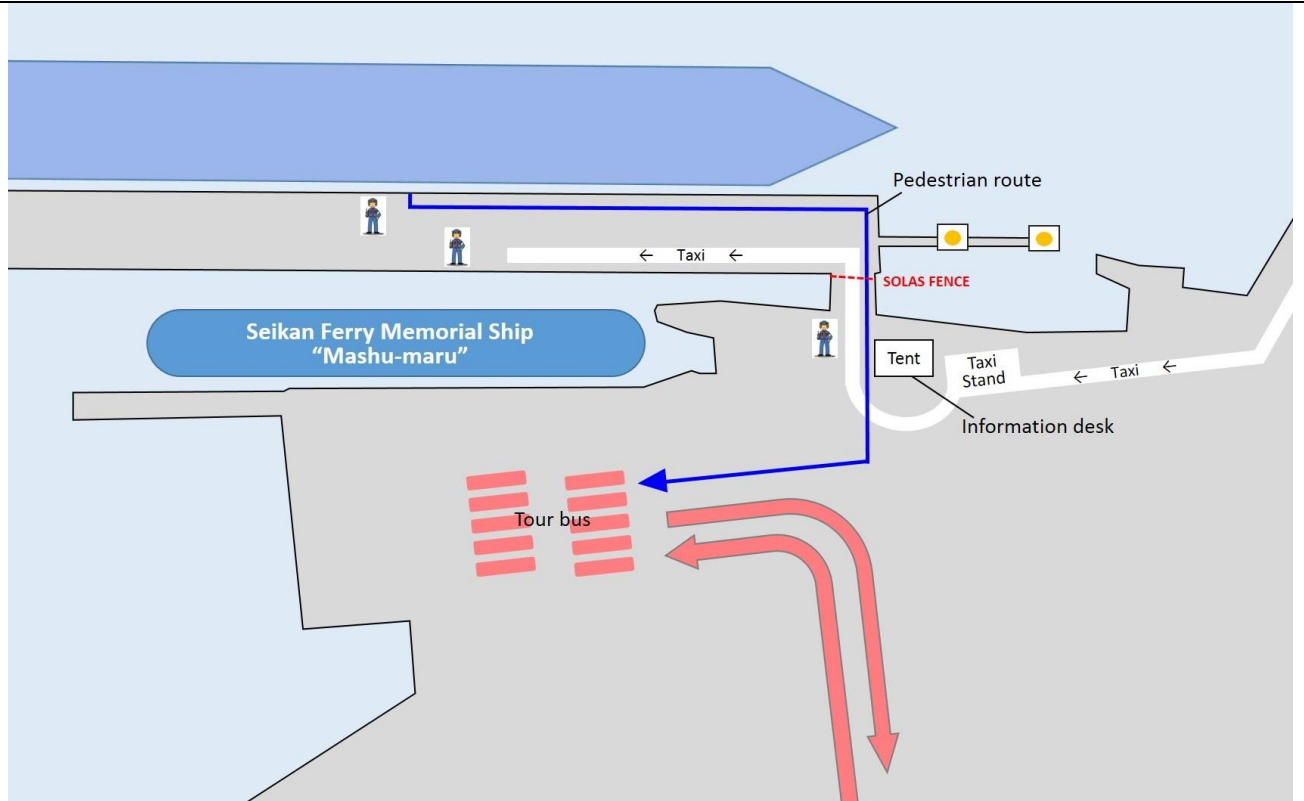

The details of a fender bar and bollard

防舷材と係船柱の詳細

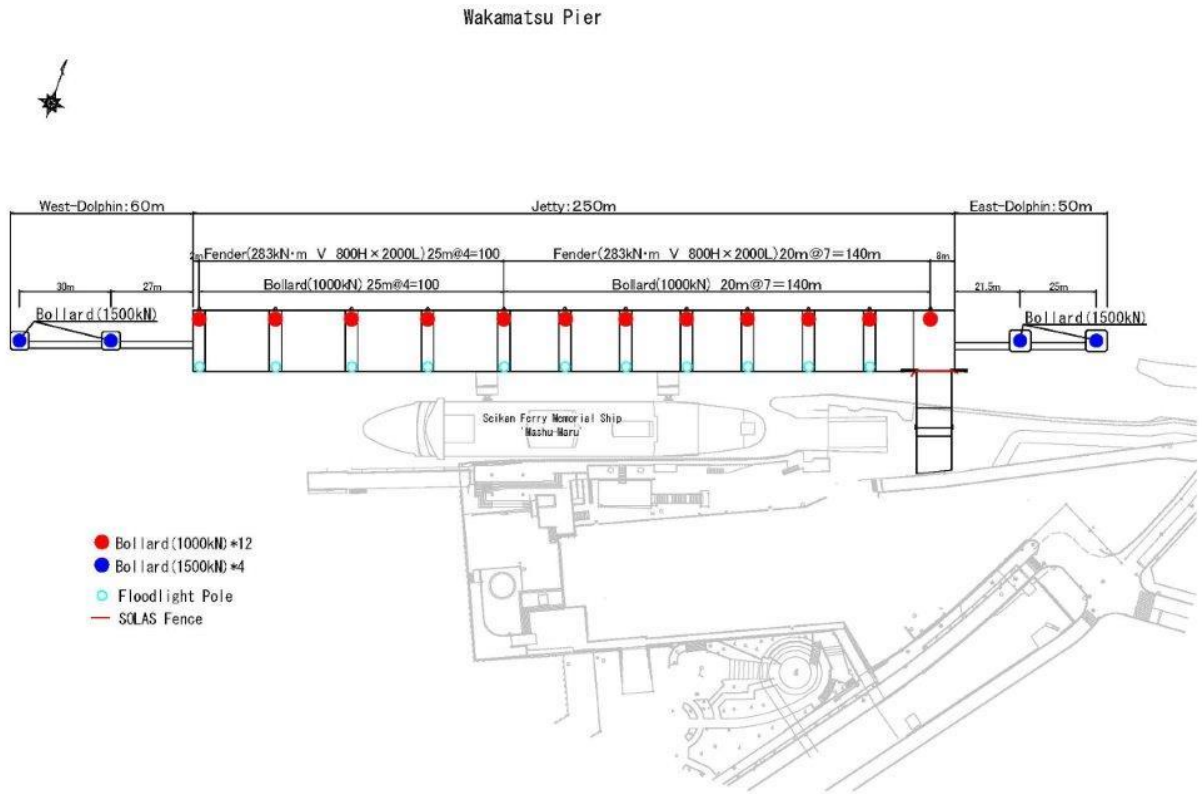

■ Wharf (Pier) Information

埠頭別情報

Wharf (Pier) name: Minato-cho Wharf ふ頭名：港町ふ頭		
III. PHYSICAL CONSIDERATIONS 物理的留意事項		
1. Berth 岸壁	Length / Water depth 延長/水深	<ul style="list-style-type: none"> • Quay A: 280m / -14m • Quay B: 240m / -12m
	Height of the pier above MLW or chart datum (平均干潮位又は海図基準からの) 岸壁の高さ	<ul style="list-style-type: none"> • Quay A: 3.3m • Quay: 3.3m
	Pier depth (distance to the closest obstruction behind the pier edge) 岸壁の幅 (岸壁の端から背後障害物までの距離)	<ul style="list-style-type: none"> • Quay A: 85m • Quay B: 85m
	Minimum depth across the berth 岸壁の最低水深	<ul style="list-style-type: none"> • Quay A: -14m • Quay B: -12m
	Fender bar 防舷材 Absorbed energy / number of the fender bars 吸収エネルギー/本数	<ul style="list-style-type: none"> • Quay A: 338kN・m, Π Shape, L:1,050 x H:1,000 / 19pcs @15m • Quay B: 216kN・m, Π Shape, L:1,100 x H:800 / 19pcs @12.5m
	Bollard 係船柱 Specification / number of the bollards スペック/本数	<ul style="list-style-type: none"> • Quay A: 1,000kN / 10pcs @30m, 1,500kN / 2pcs @210m (Storm Bitt) +2,000kN / 1pcs (Storm Bitt) • Quay B: 700kN / 10pcs @25m, 1,000kN / 2pcs @170m (Storm Bitt) +2,000kN / 1pcs (Storm Bitt)
2. Channel 航路	Width / water depth 幅/水深	• 300m / -14m~-16m
3. Turning basin (diameter) 回頭泊地 (直径)		• 696m
4. Clearance 高さ制限		• No Limit
5. Maximum tidal range / max currents 最大潮差/最大潮流		• 1.1m / 0.1knot
6. Wind & weather conditions / tides by season 風及び季節による天候/潮汐の変化		<ul style="list-style-type: none"> • Less than 5m/s (82.3%) and more than 10m/s (0.6%) [Mar-May] W or WNW: 50%, [Mar-May] Less than 0.1knot: 71%, [Mar-May] More than 0.2knot: 2% [Jun-Aug] E or ESE: 77%, [Jun-Aug] Less than 0.1knot: 82%, [Jun-Aug] More than 0.2knot: 1% [Sep-Nov] W or WNW: 55%, [Sep-Nov] Less than 0.1knot: 77%, [Sep-Nov] More than 0.2knot: 1%

IV. LANDSIDE FACILITIES		
陸上施設		
1. Terminal ターミナル等	Terminal Availability ターミナルの有無	Not available
	Shelter or facilities to shelter from rain (無い場合) 雨よけ施 設の有無	Not available
	Boarding Bridge ボーディングブリッジ	Not available
2. Shore gangway ギャングウェイ		Not available
3. Pay phone 公衆電話		Not available
4. Restroom / washroom トイレ		Available
5. Vending machine / kiosk 自動販売機・売店		Not available
6. Need to arrange shuttles to downtown? 市街地へシャトルバスが必要か		Yes
7. Distance and time to downtown? 市街地までの距離・時間		6km / 20min by car
8. Distance and time to primary sightseeing area 主要観光地までの距離・時間		Morning Market: 6km / 20min by car
V. CUSTOMS AND IMMIGRATION		
税関及び入国管理		
1. Availability of CIQ services and facilities CIQの有無	Permanent 常設	
	Temporary 仮設 (船上を含む)	Yes
2. Secure electronic access 自動化出入国ゲートの有無		Not available
VI. WORKING HOURS		
サービス提供時間		
1. Pilotage パイロット		24hrs
2. Tuggage タグ		24hrs
3. Line handling 綱とり		24hrs
4. Other (pls specify) その他		
VII. SECURITY		
セキュリティ		
1. ISPS certified? ISPSの認定有無		Yes

VIII. TRANSPORTATION 交通機関		
1. Parking for tour buses (number of buses) 観光バス待機所 (駐車台数)		More than 50
2. Parking for private cars (number of cars) 自家用車駐車場 (駐車台数)		More than 50
3. Parking for taxis (number of taxis) タクシープール (駐車台数)		More than 50
4. Name of the nearest airport from the pier ふ頭から最も近い空港の名称		Hakodate Airport
5. Time from the pier to the airport by car ふ頭から空港までの車での移動時間		30min
6. Name of the nearest rail station from the pier ふ頭から最も近い鉄道駅の名称		JR Goryokaku Station
7. Time from the pier to the rail station by car ふ頭から鉄道駅までの車での移動時間		10min
IX. TERMINAL SERVICE ターミナル内のサービス		
1. Wi-Fi service Wi-Fi サービス		Available
2. Postal & delivery service 郵便・宅配便サービス		Not available
3. Foreign exchange 外貨両替所	Availability 両替所の有無	Not available
	Kinds of currencies 取り扱い貨幣の種類	
	Business hours・days 営業時間・営業日	
4. Tourist information 観光案内所	Availability 観光案内所の有無	Available (temporary)
	Language 対応言語	English, Japanese
	Business hours・days 営業時間・営業日	Temporary

X. REFERENCE INFORMATION

参考情報

Wharf position figure

ふ頭位置図

<https://www.city.hakodate.hokkaido.jp/docs/2019020800086/>

Figure of the terminal placement and passenger line of flow
ターミナル配置図と受入動線

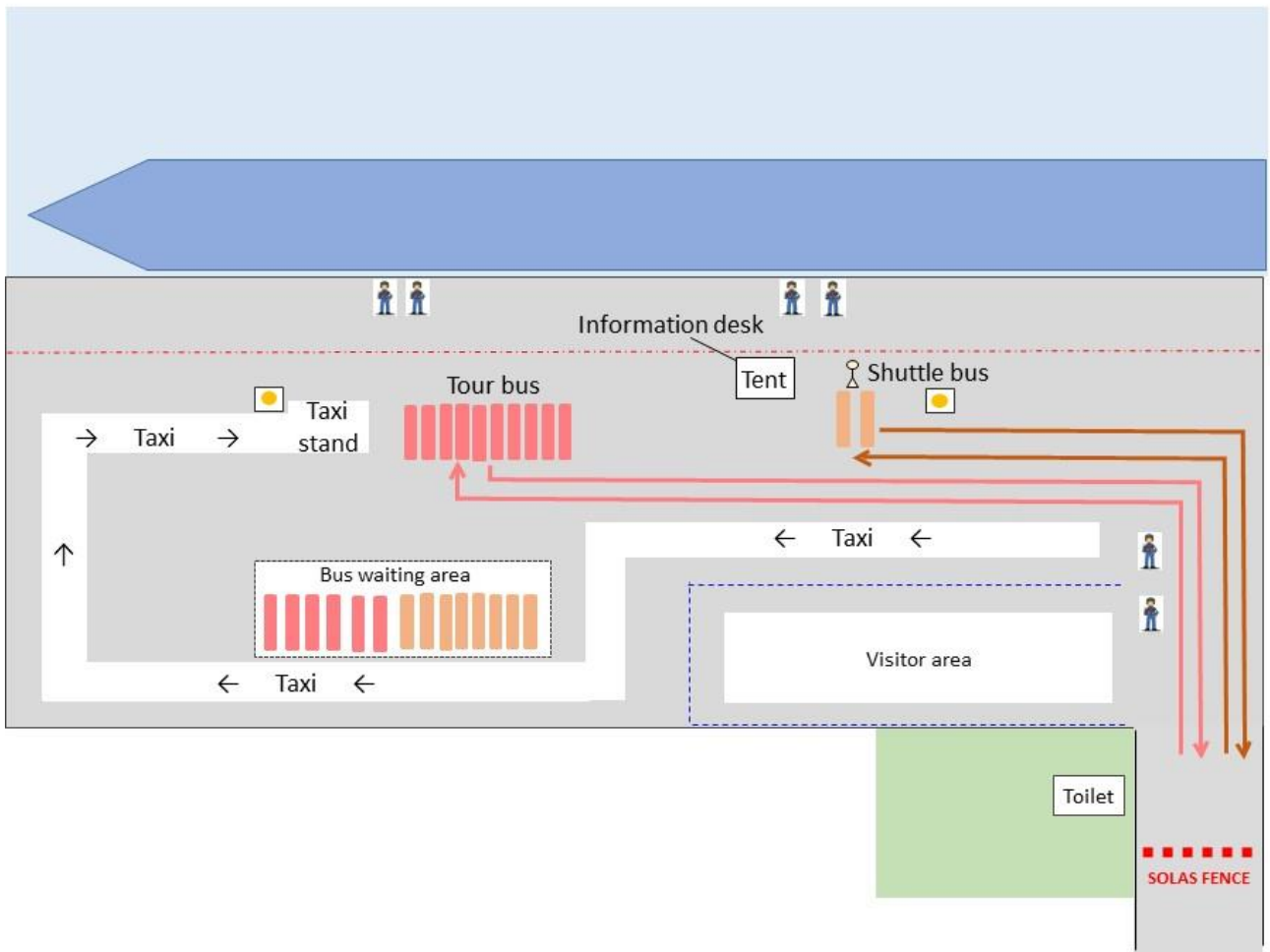

The details of a fender bar and bollard

防舷材と係船柱の詳細

PORT of HAKODATE MINATOCHO WHARF

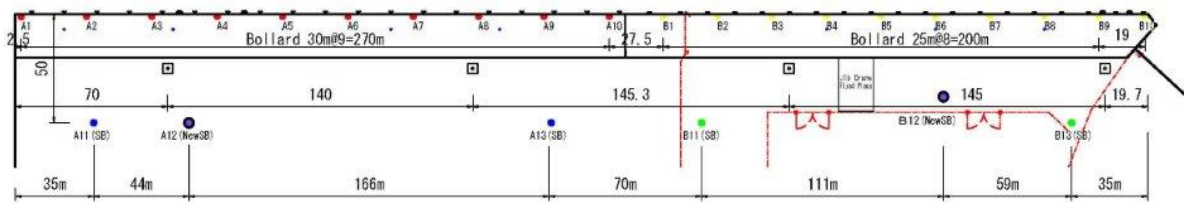
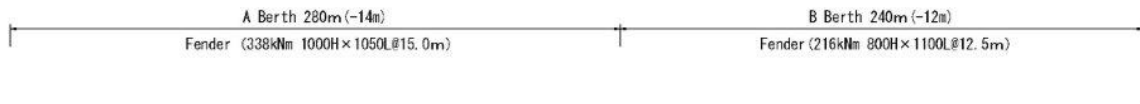

- Bollard (1000kN) *10
- Bollard (700kN) *10
- Storm Bit (1500kN) *2
- Storm Bit (1000kN) *2
- New Storm Bit (2000kN) *2
- Floodlight Pole
- SOLAS Fence

■ Wharf (Pier) Information

埠頭別情報

Wharf (Pier) name: Nishi Wharf ふ頭名：西ふ頭		
III. PHYSICAL CONSIDERATIONS 物理的留意事項		
1. Berth 岸壁	Length / Water depth 延長/水深	• 165m / -9m
	Height of the pier above MLW or chart datum (平均干潮位又は海図基準 からの) 岸壁の高さ	• 2.8m
	Pier depth (distance to the closest obstruction behind the pier edge) 岸壁の幅 (岸壁の端から背 後障害物までの距離)	• 59m
	Minimum depth across the berth 岸壁の最低水深	• -9m
	Fender bar 防舷材 Absorbed energy / number of the fender bars 吸収エネルギー/本数	• 120kN・m, V Shape, L:1,500 x H:600 / 17pcs @12m
	Bollard 係船柱 Specification / number of the bollards スペック/本数	• 350kN / 7pcs @25m • 250kN / 9pcs @25m *Installed between each of 350kN bollards • 700kN / 2pcs @120m (Storm Bitt)
2. Channel 航路	Width / water depth 幅/水深	• 300m / -10m~-16m
3. Turning basin (diameter) 回頭泊地 (直径)		• 367m
4. Clearance 高さ制限		• No Limit
5. Maximum tidal range / max currents 最大潮差/最大潮流		• 1.1m / 0.1knot
6. Wind & weather conditions / tides by season 風及び季節による天候/潮汐の変化		• Less than 5m/s (82.3%) and more than 10m/s (0.6%) [Mar-May] W or WNW: 50%, [Mar-May] Less than 0.1knot: 71%, [Mar-May] More than 0.2knot: 2% [Jun-Aug] E or ESE: 77%, [Jun-Aug] Less than 0.1knot: 82%, [Jun-Aug] More than 0.2knot: 1% [Sep-Nov] W or WNW: 55%, [Sep-Nov] Less than 0.1knot: 77%, [Sep-Nov] More than 0.2knot: 1%

IV. LANDSIDE FACILITIES		
陸上施設		
1. Terminal ターミナル等	Terminal Availability ターミナルの有無	Not available
	Shelter or facilities to shelter from rain (無い場合) 雨よけ施 設の有無	Not available
	Boarding Bridge ボーディングブリッジ	Not available
2. Shore gangway ギャングウェイ		Not available
3. Pay phone 公衆電話		Not available
4. Restroom / washroom トイレ		Available
5. Vending machine / kiosk 自動販売機・売店		Not available
6. Need to arrange shuttles to downtown? 市街地へシャトルバスが必要か		Yes
7. Distance and time to downtown? 市街地までの距離・時間		3km / 10min by car
8. Distance and time to primary sightseeing area 主要観光地までの距離・時間		Morning Market: 3km / 10min by car
V. CUSTOMS AND IMMIGRATION		
税関及び入国管理		
1. Availability of CIQ services and facilities CIQ の有無	Permanent 常設	
	Temporary 仮設 (船上を含む)	Yes
2. Secure electronic access 自動化出入国ゲートの有無		Not available
VI. WORKING HOURS		
サービス提供時間		
1. Pilotage パイロット		24hrs
2. Tugage タグ		24hrs
3. Line handling 綱とり		24hrs
4. Other (pls specify) その他		
VII. SECURITY		
セキュリティ		
1. ISPS certified? ISPS の認定有無		Yes

VIII. TRANSPORTATION 交通機関		
1. Parking for tour buses (number of buses) 観光バス待機所 (駐車台数)		More than 30
2. Parking for private cars (number of cars) 自家用車駐車場 (駐車台数)		More than 30
3. Parking for taxis (number of taxis) タクシープール (駐車台数)		More than 20
4. Name of the nearest airport from the pier ふ頭から最も近い空港の名称		Hakodate Airport
5. Time from the pier to the airport by car ふ頭から空港までの車での移動時間		30min
6. Name of the nearest rail station from the pier ふ頭から最も近い鉄道駅の名称		JR Hakodate Station
7. Time from the pier to the rail station by car ふ頭から鉄道駅までの車での移動時間		10min
IX. TERMINAL SERVICE ターミナル内のサービス		
1. Wi-Fi service Wi-Fi サービス		Available
2. Postal & delivery service 郵便・宅配便サービス		Not available
3. Foreign exchange 外貨両替所	Availability 両替所の有無	Not available
	Kinds of currencies 取り扱い貨幣の種類	
	Business hours・days 営業時間・営業日	
4. Tourist information 観光案内所	Availability 観光案内所の有無	Available (temporary)
	Language 対応言語	English, Japanese
	Business hours・days 営業時間・営業日	Temporary

X. REFERENCE INFORMATION

参考情報

Wharf position figure

ふ頭位置図

<https://www.city.hakodate.hokkaido.jp/docs/2019020800086/>

Figure of the terminal placement and passenger line of flow

ターミナル配置図と受入動線

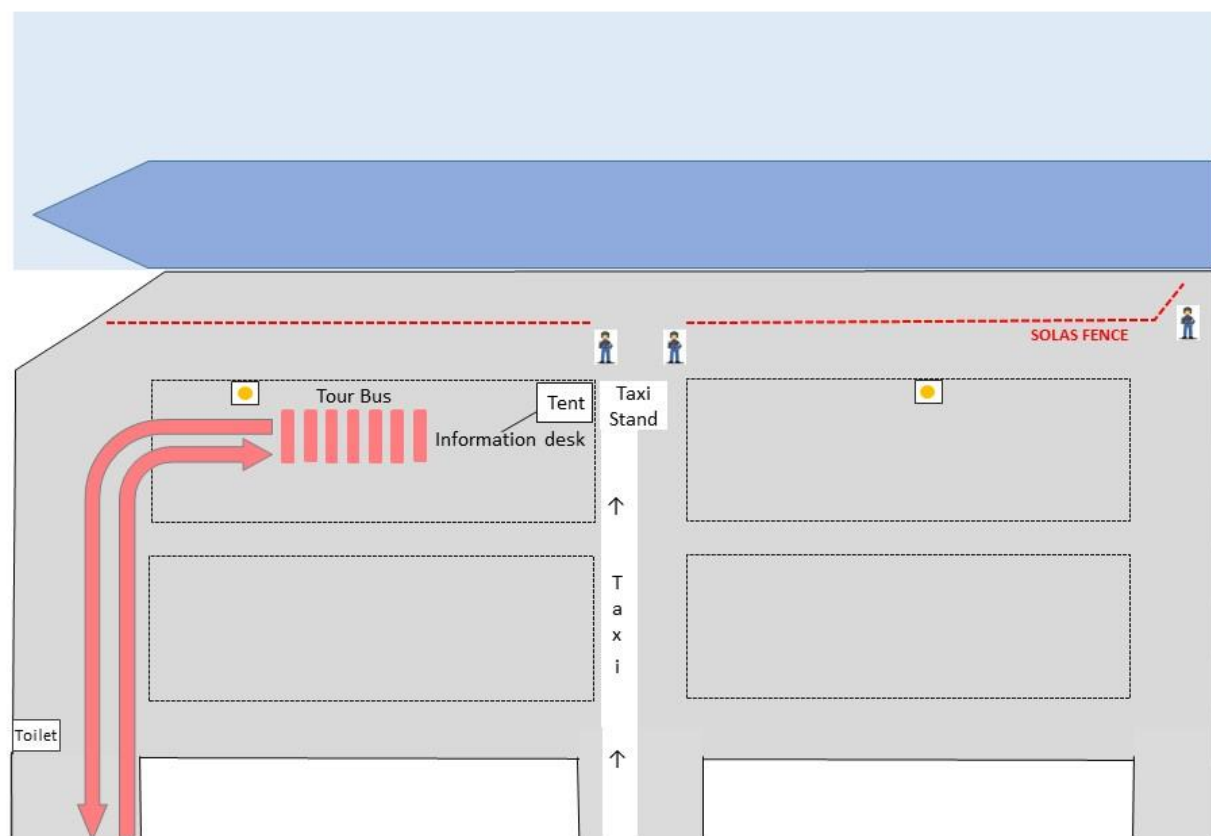

The details of a fender bar and bollard

防舷材と係船柱の詳細

