

CRUISE SHIP PIER AND TERMINAL FACILITY SPECIFICATION OVERVIEW

クルーズ係留施設及びターミナル施設概要

As of 01/01/2023
2023年1月1日現在

■ Common Information

共通情報

PORT NAME: Port of Kochi 港名：		
LOCATION / ADDRESS: 4704, Shinkou, Niida, Kochi City, Kochi, 781-0112, Japan 住所：		
PORT CONTACT: Port Promotion Division, Kochi Prefectural Government 連絡先： (1-2-20 Marunouchi, Kochi City, Kochi,780-8570, Japan)		
Phone: +81 88 823 9890 電話：	Fax: +81 88 823 9657	E-mail: 175201@ken.pref.kochi.lg.jp
Mobile phone: - 携帯：	Website: -	Other: - その他：

I. CRUISE SHIP RECORD (OVER THE PAST FIVE YEARS)

寄港実績 (過去5年)

Ship name 船名：	Gross tonnage 総トン数：	LOA 全長：	Draft 喫水：	Maiden call (Year) 初寄港年：
ASUKA II	50,142	240.90	7.80	
NIPPON MARU	22,472	166.65	6.56	
PACIFIC VENUS	26,594	183.40	6.52	
CELEBRITY MILLENNIUM	90,963	294.00	8.30	2015
LE SOREAL	10,700	142.10	4.80	2016
MARINER OF THE SEAS	138,279	311.12	8.60	2016
GOLDEN PRINCESS	108,865	289.51	8.45	2016
VOYAGER OF THE SEAS	137,276	311.12	8.80	2016
DIAMOND PRINCESS	115,906	290.00	8.55	2016
QUANTUM OF THE SEAS	168,666	347.08	8.82	2016
OVATION OF THE SEAS	167,800	348.00	8.50	2016
ARCADIA	84,342	285.10	8.00	2017
QUEEN ELIZABETH	90,901	294.00	7.90	2017
SAPPHIRE PRINCESS	115,875	290.00	8.55	2017
SEABOURN SOJURN	32,346	198.19	6.40	2017
NORWEGIAN JOY	167,800	333.46	8.70	2017
COSTA FORTUNA	102,587	272.20	8.20	2017
SUPERSTAR VIRGO	75,338	268.60	7.90	2017
COSTA ATLANTICA	85,619	292.56	8.00	2017
COSTA SERENA	114,147	289.59	8.30	2017
MSC LIRICA	65,591	274.90	6.80	2017
COSTA NEOROMANTICA	56,769	220.52	7.60	2017
MAJESTIC PRINCESS	144,216	330.00	8.55	2017
SEVEN SEAS VOYAGER	42,367	206.00	7.10	2017
STAR LEGEND	9,961	133.80	5.20	2018

VOLENDAM	61,214	237.91	8.10	2018
NORWEGIAN JEWEL	93,502	294.13	8.30	2018
MSC SPLENDIDA	137,936	335.00	8.67	2018
AMSTERDAM	62,735	237.83	8.11	2018
SEVEN SEAS MARINER	48,075	216.00	7.00	2019
WESTERDAM	82,862	285.24	8.00	2019
COSTA VENEZIA	135,500	323.60	8.55	2019
MAASDAM	55,575	219.21	7.72	2019
AZAMARA QUEST	30,277	181.00	5.95	2019

II. CONSULATE OR EMBASSY CONTACT 大使館または領事館連絡先・所在地			
Nation: 国名 :	Name of consulate or embassy: 大使館または領事館名 :	Phone: 電話番号 :	Place: 所在地 :
Australia	Australian Consulate-General Osaka	+81-06-6941-9271	Osaka
Canada	Embassy of Canada in Japan	+81-3-5412-6200	Tokyo
China	Consulate-General of the People's Republic of China in Osaka	+81-06-6445-9481	Osaka
Germany	German Consulate Osaka-Kobe	+81-6-6440-5070	Osaka
Italy	Consulate-General of Italy in Osaka	+81-6-4706-5820	Osaka
Korea	Consulate-General of the Republic of Korea in Hiroshima	+81-082-568-0502	Hiroshima
Singapore	Honorary Consulate-General of the Republic of Singapore in Osaka	+81-072-223-6911	Osaka
United Kingdom	British Embassy Tokyo	+81-3-5211-1100	Tokyo
United States	Consulate-General of the United States of America in Osaka-Kobe	+81-06-6315-5900	Osaka

■ Wharf (Pier) Information

埠頭別情報

Wharf (Pier) name: Misato Berth No 7 th ふ頭名 :		
III. PHYSICAL CONSIDERATIONS 物理的留意事項		
1. Berth 岸壁	Length / Water depth 延長/水深	①No.7-1 240m / -8m ②No.7-2 240m / -12m ③No.7-3 280m / -12m ④No.7-4 190m / -11m
	Height of the pier above MLW or chart datum (平均干潮位又は海図基準 からの) 岸壁の高さ	①No.7-1 4.50m ②No.7-2 4.55m ③No.7-3 4.50m ④No.7-4 4.50m
	Pier depth (distance to the closest obstruction behind the pier edge) 岸壁の幅 (岸壁の端から背 後障害物までの距離)	①No.7-1 130m ②No.7-2 130m ③No.7-3 32.5m ④No.7-4 32.5m
	Minimum depth across the berth 岸壁の最低水深	①No.7-1 -8m (130m) ②No.7-2 -12m (240m) ③No.7-3 -12m(280m) ④No.7-4 -11m(190m)
	Fender bar 防舷材 Absorbed energy / number of the fender bars 吸収エネルギー/本数	①No.7-1 291.3kN・m / 23 ②No.7-2 291.3kN・m / 24 ③No.7-3 392.0kN・m / 21 ④No.7-4 344.0kN・m / 16
	Bollard 係船柱 Specification / number of the bollards スペック/本数	①No.7-1&7-2 70t / 24, 100t / 1 ②No.7-3&7-4 50t / 11, 100t / 14, 150t / 5
2. Channel 航路	Width / water depth 幅/水深 300m/-12m	
3. Turning basin (diameter) 回頭泊地 (直径)	② No.7-1&7-2 580m ②No.7-3&7-4 724m	
4. Clearance 高さ制限	No limit	
5. Maximum tidal range / max currents 最大潮差/最大潮流	<Tidal range> HHW: 4.220m / LLW: -0.440m <Currents> NE2.3cm/s at 3 hours after high tide SE5.0cm/s at 3 hours after low tide	
6. Wind & weather conditions / tides by season 風及び季節による天候/潮汐の変化	Wind speed frequency (all year) Under 5m/s: 94.1%, over 10m/s: 0.3%	

IV. LANDSIDE FACILITIES		
陸上施設		
1. Terminal ターミナル等	Terminal Availability ターミナルの有無	Available
	Shelter or facilities to shelter from rain (無い場合) 雨よけ施 設の有無	
	Boarding Bridge ボーディングブリッジ	None
2. Shore gangway ギヤングウェイ		None
3. Pay phone 公衆電話		None
4. Restroom / washroom トイレ		Available
5. Vending machine / kiosk 自動販売機・売店		Available
6. Need to arrange shuttles to downtown? 市街地へシャトルバスが必要か		There is no public transportation between the pier and city. It is necessary to use taxis or shuttle buses.
7. Distance and time to downtown? 市街地までの距離・時間		About 30 minutes by car to Kochi City Center
8. Distance and time to primary sightseeing area 主要観光地までの距離・時間		About 30 minutes by car to Kochi Castle About 10 minutes by car to Katsurahama Beach
V. CUSTOMS AND IMMIGRATION		
税関及び入国管理		
1. Availability of CIQ services and facilities CIQの有無	Permanent 常設	Available
	Temporary 仮設 (船上を含む)	
2. Secure electronic access 自動化出入国ゲートの有無		None
VI. WORKING HOURS		
サービス提供時間		
1. Pilotage パイロット		24hrs
2. Tugage タグ		24hrs
3. Line handling 綱とり		24hrs
4. Other (pls specify) その他		-
VII. SECURITY		
セキュリティ		
1. ISPS certified? ISPSの認定有無		Yes

VIII. TRANSPORTATION 交通機関		
1. Parking for tour buses (number of buses) 観光バス待機所 (駐車台数)		120
2. Parking for private cars (number of cars) 自家用車駐車場 (駐車台数)		160
3. Parking for taxis (number of taxis) タクシールール (駐車台数)		30
4. Name of the nearest airport from the pier ふ頭から最も近い空港の名称		Kochi Ryoma Airport
5. Time from the pier to the airport by car ふ頭から空港までの車での移動時間		20min
6. Name of the nearest rail station from the pier ふ頭から最も近い鉄道駅の名称		JR Kochi Station
7. Time from the pier to the rail station by car ふ頭から鉄道駅までの車での移動時間		30 min
IX. TERMINAL SERVICE ターミナル内のサービス		
1. Wi-Fi service Wi-Fi サービス		Available (Temporary)
2. Postal & delivery service 郵便・宅配便サービス		Under negotiation
3. Foreign exchange 外貨両替所	Availability 両替所の有無	Available(Temporary)
	Kinds of currencies 取り扱い貨幣の種類	US,AUS dollar, Chinese yuan, Japanese yen, etc
	Business hours・days 営業時間・営業日	Temporary
4. Tourist information 観光案内所	Availability 観光案内所の有無	Available(Temporary)
	Language 対応言語	English, Korean, Chinese and Japanese
	Business hours・days 営業時間・営業日	Temporary

X. REFERENCE INFORMATION

参考情報

Wharf position figure

ふ頭位置図

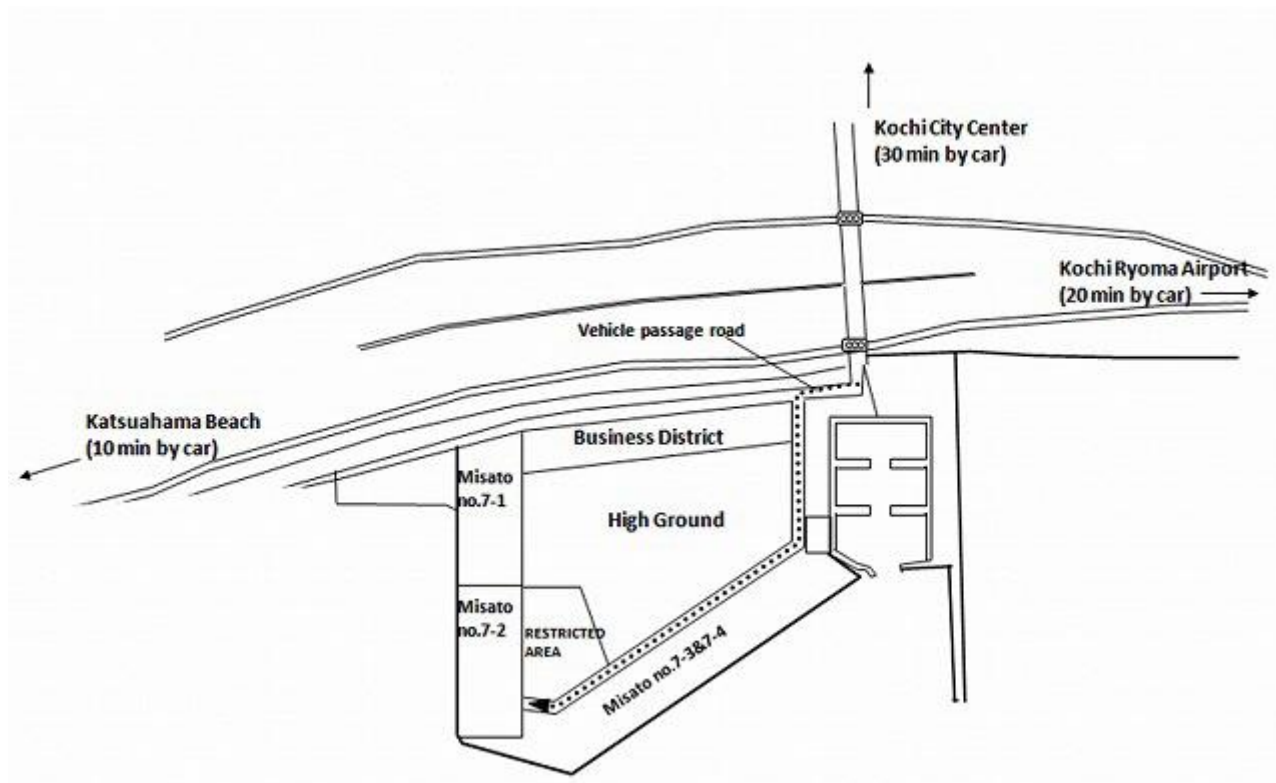
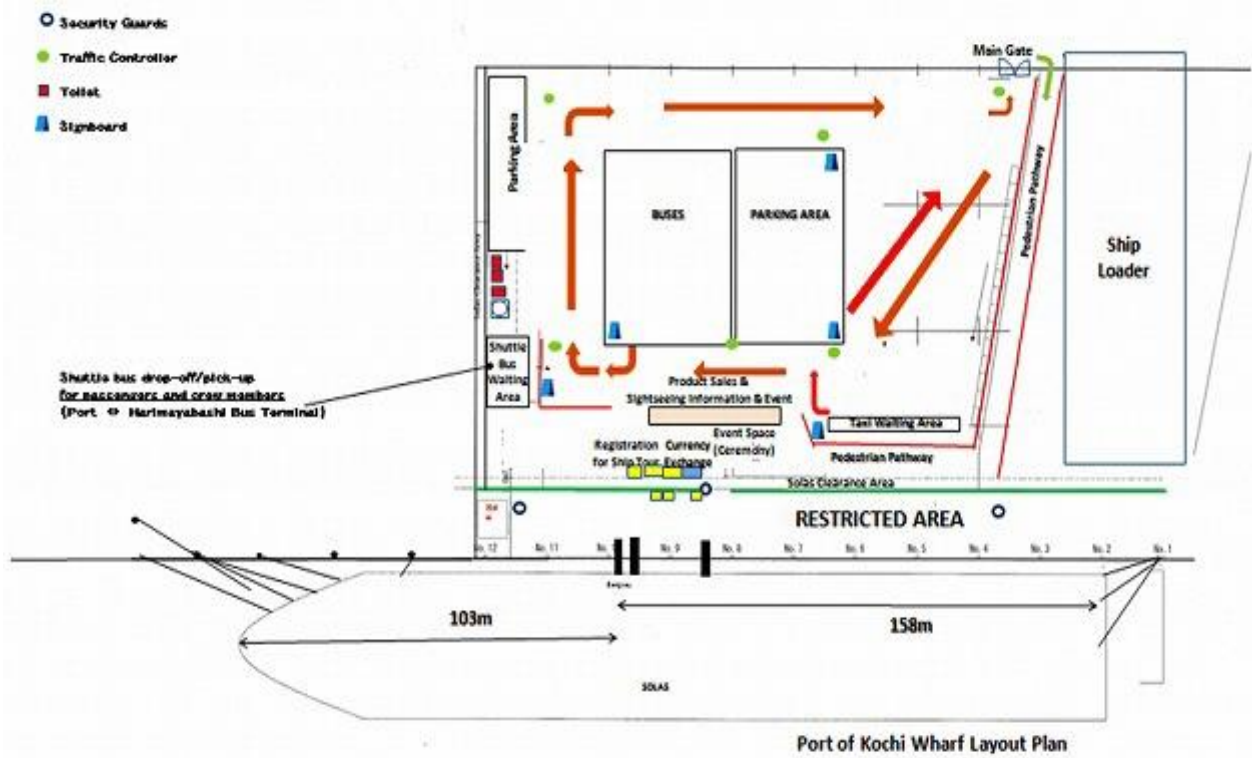
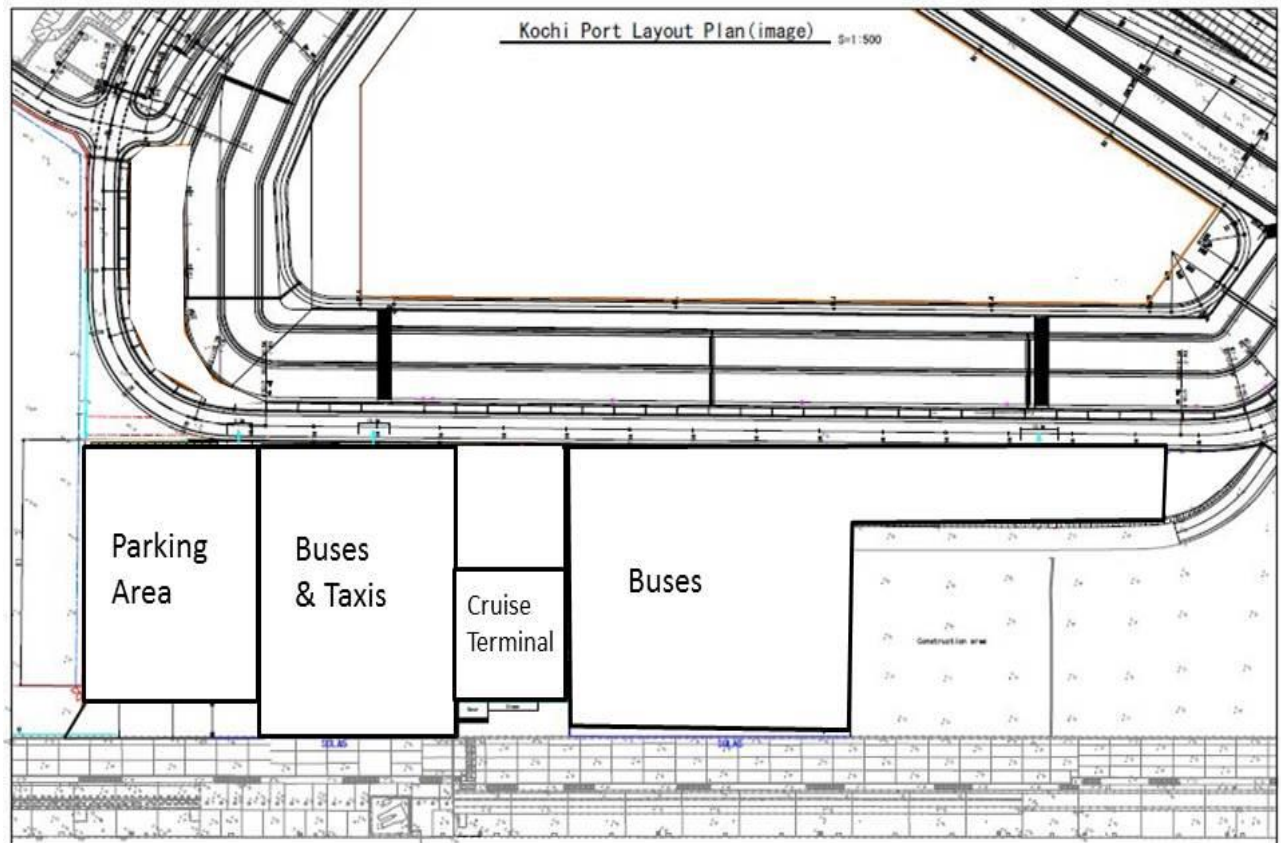

Figure of the terminal placement and passenger line of flow
 ターミナル配置図と受入動線

Misato no.7-1 & 7-2



Misato no.7-3 & 7-4



The details of a fender bar and bollard
防舷材と係船柱の詳細

Misato no.7-1&7-2

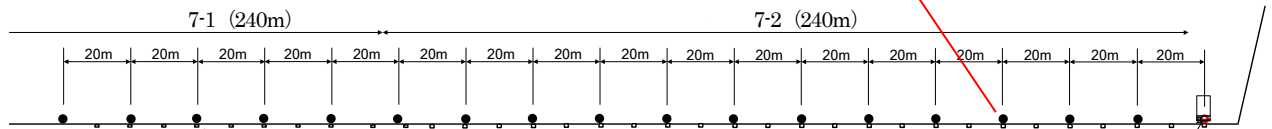

- 100t bollard
- 70t bollard



Misato no.7-3&7-4

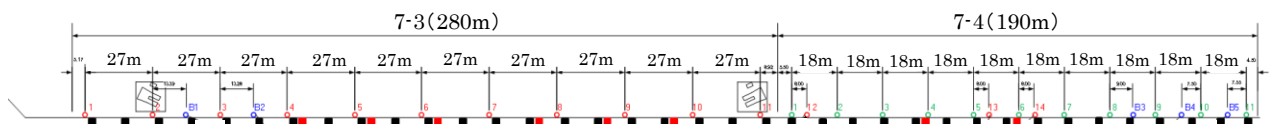

- 150t bollard
- 100t bollard
- 50t bollard

